

# Monitor Nozzles

## Fog Nozzle Model 9000



### Description

The Model 9000 fog nozzle is a single flow fog nozzle that maintains essentially the same flow rate when adjusted from straight stream to wide fog.

Nozzles can be supplied with customised flow rates. The data below is for two of many flow options.

The 9000 is a constant flow nozzle with a 100mm BSP fixed base. Flows in the range 4,500 lpm to 8,000 lpm at 700 kPa are possible with this nozzle.

Length: 210mm

Diameter: 190mm

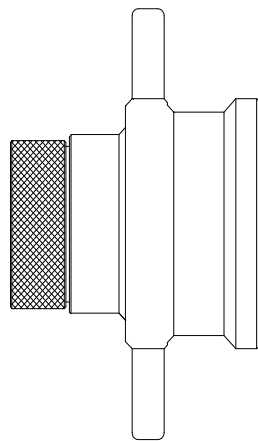

### Materials of Construction

LG2 Gunmetal (Bronze)

Seawater applications we recommend using nickel plated gunmetal construction for the longest trouble free service life.

### Performance Data

This data is for the furthest water drop in approximately still air conditions and with the nozzle mounted on a monitor aimed 25° above horizontal. This is the standard method of rating fog nozzles, however, even a slight cross or head wind will reduce the throw by about 5 meters and an allowance for this should be made when designing systems.

---

ORION SAFETY INDUSTRIES PTY LIMITED

A.C.N. 002 538 696

Tel (61) 2 9821 2244 29 SHEPHERD STREET LIVERPOOL NSW 2170 FAX (61) 2 9821 2906  
AUSTRALIA

### **5,680 lpm (1,500 US gpm) Stem**

		STRAIGHT STREAM	NARROW FOG	WIDE FOG
PRESSURE	FLOW (lpm)	THROW (M)	THROW (M)	THROW (M)
600 kPa	5,260	65	40	28
700 kPa	5,580	69	42	30
800 kPa	6,070	75	45	33
900 kPa	6,440	79	48	36
1000 kPa	6,790	85	50	39

### **7,570 lpm (2,000 US gpm) Stem**

		STRAIGHT STREAM	NARROW FOG	WIDE FOG
PRESSURE	FLOW (lpm)	THROW (M)	THROW (M)	THROW (M)
600 kPa	7,005	69	41	28
700 kPa	7,570	76	44	30
800 kPa	8,090	83	48	33
900 kPa	8,580	89	51	36
1000 kPa	9,040	93	53	39

### **Alternative Construction**

Hard anodise aluminium  
Electroless nickel plating